

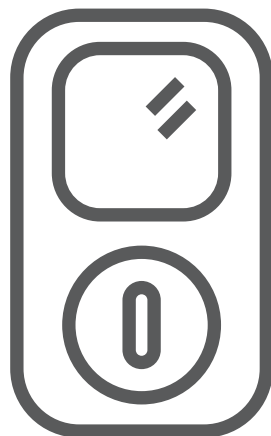

SMART LOCK

User Manual



Applicable Models: M1-BF, M1-B, M1 set



Scan Me

Installation Video



Next lock App



Contents

In the Box	01
Preparation	02
Check Your Door Dimensions	02
Installation	03
Install the Deadbolt	03
Install the Strike Plate	04
Install the Exterior Assembly	05
Install the Mounting Plate	06
Install the Interior Assembly	07
Insert the Batteries	09
Test the Lock	10
Using the App	11
Create an Account	11
Pair Your Phone with the Smart Lock	12
Select the Door Opening Direction	13
Modify the Admin Passcode	14
APP Homepage Overview	15
Unlock/Lock by the APP (Bluetooth)	16
Set Customized Passcodes	17
Share Ekeys	18
Add Authorized Admin	19
Set IC Cards (up to 1000)	20
Add Fingerprints (up to 50)	22
Auto Lock/Passcode Mode	24
Lock Setting	25

Basic Operations	26
Unlock the Door	26
Lock the Door	26
How to Reset the Lock	27
Gateway Location Diagram	28
Smart Home Integration	29
Pair the Gateway	29
Enable the Amazon Alexa	32
Enable the Google Home/Assistant	34
Enable PC Operation	35
FAQs	36
Smart Locks Chart	39
Customer Service	39

Customer Service

All Hornbill products come with lifetime support. Feel free to contact us if you have any questions.

Email: support@hornbilllock.com

Toll free: 1-866-985-9909

Mon-Sun: 12:00 pm–5:00 am (EDT)



WhatsApp



Facebook Group



In the box

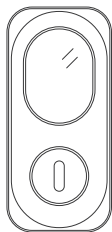

Exterior Assembly

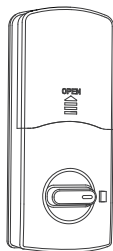

Interior Assembly

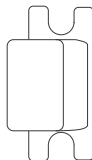

Strike Pad

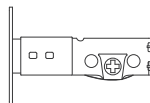

Deadbolt

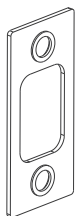

Strike Plate

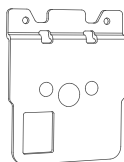

Mounting Plate

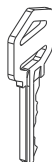

Key

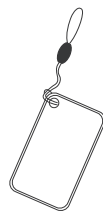

IC Card

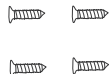

Deadbolt/Strike
Screws



Interior Assembly/
Mounting Plate Screws



User Manual



Preparation

Check Your Door Dimensions

Cross bore diameter:

54 mm (2.13 inches)

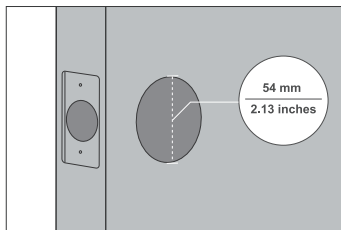

Backset:

60 /70 mm (2.36 / 2.76 inches)

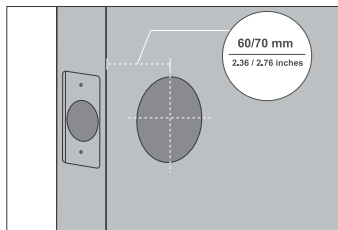

Door thickness:

38 to 48 mm (1.5 / 1.89 inches)

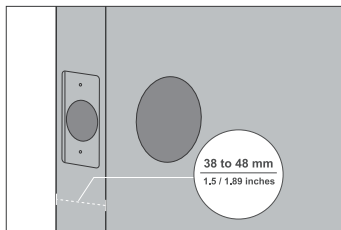

Edge bore diameter:

24 mm (0.94 inch)

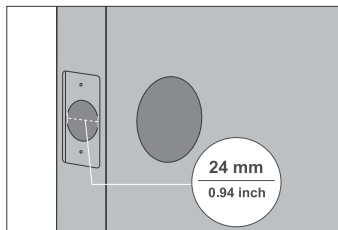



Installation

Step 1: Install the Deadbolt

- If your door has a 60mm/2.36 inches backset, you can install the deadbolt without any adjustments.

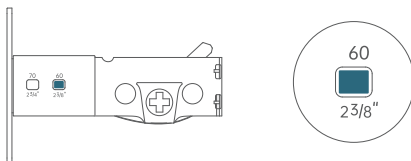

- For doors with a 70mm/2.76 inches backset, the deadbolt length needs to be extended first. To do this, rotate the deadbolt cover upwards and pull it to extend the length. Then, rotate the cover downwards to lock the deadbolt in place.

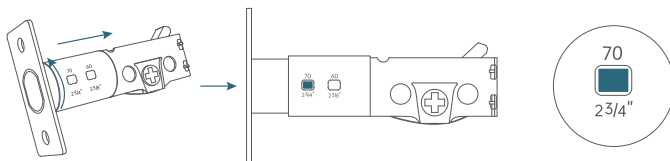

1. Insert the retracted deadbolt with the word “UP” and up arrow facing upwards.

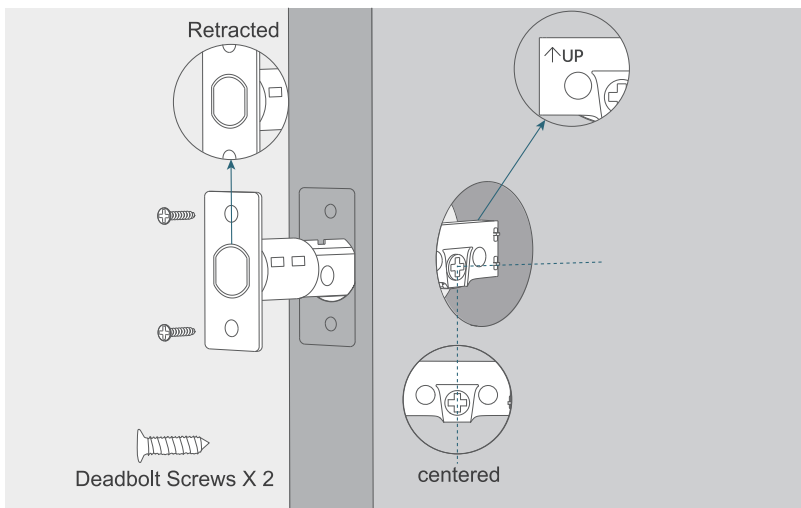



2. Screw the deadbolt with a screwdriver (not provided).

Parts Required:

Deadbolt, Deadbolt Screws, Philips Screwdriver (not provided)

Step 2: Install the Strike Plate

Put the strike pad into the door frame first, and then screw the strike plate in place.

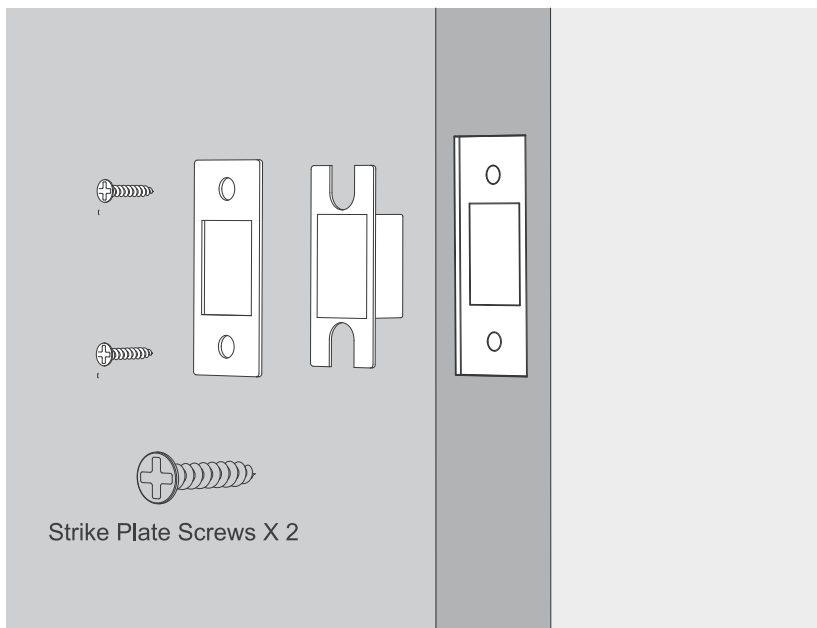

Parts Required: Strike Plate, Strike Pad, Strike Screws, Screwdriver



Step 3: Install the Exterior Assembly

1. Place the spindle horizontally before inserting it.
2. Turn the spindle several times to test whether the deadbolt extends or retracts smoothly.
3. Keep the spindle horizontal and pass the cable under the deadbolt.

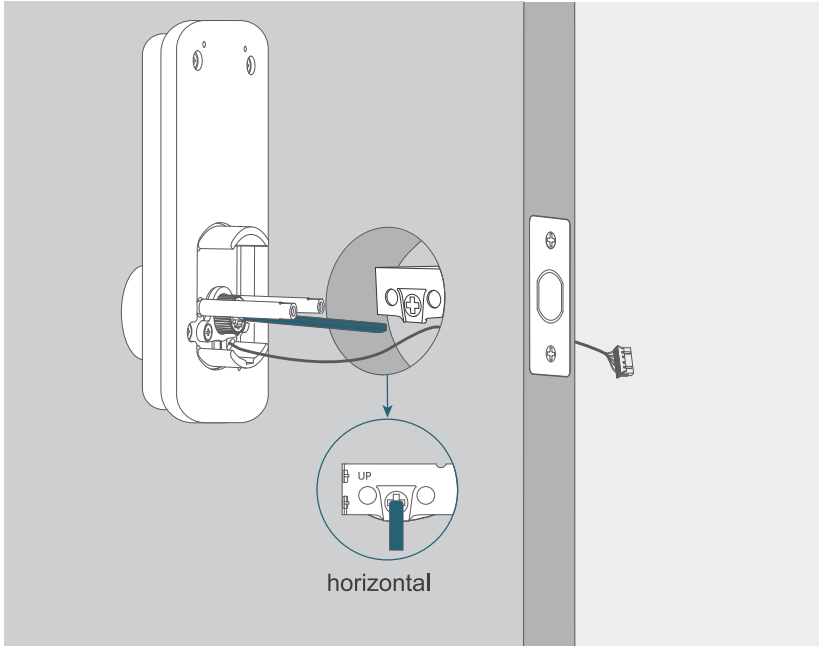

Note: Keep the deadbolt retracted (in unlocked status) and do not insert any keys during installation.

Parts Required: Exterior Assembly



Step 4: Install the Mounting Plate

1. Pass the spindle through the central hole and the cable through the right bottom hole.
2. Screw the mounting plate firmly while ensuring proper alignment.

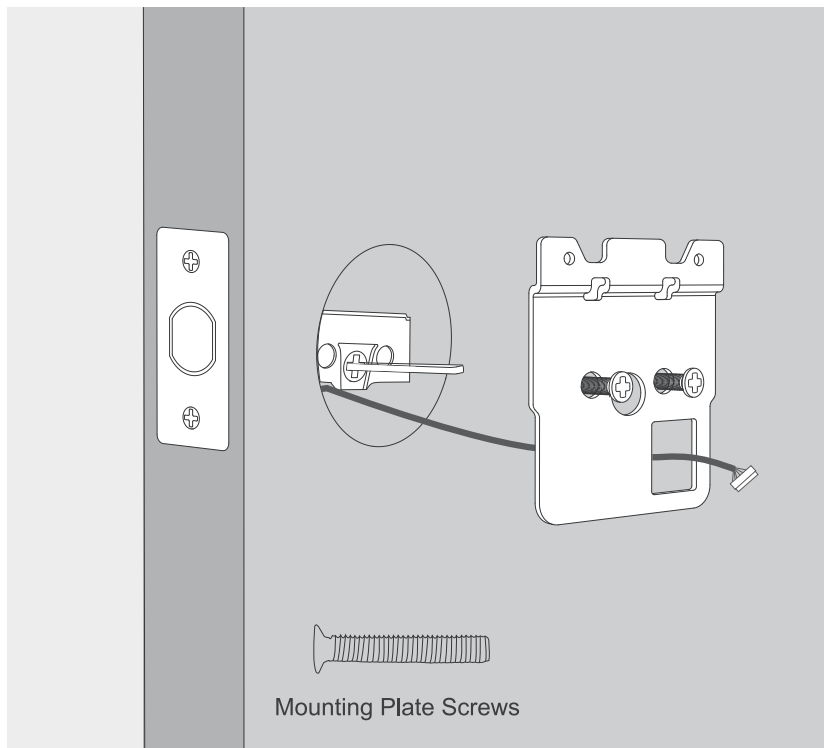

Note: Please keep the exterior assembly straight when installing the mounting plate.

Parts Required: Mounting Plate, Mounting Plate Screws, Screwdriver (not provided)

Step 5: Install the Interior Assembly

1. Plug the cable into the port on the circuit board. Make sure the connector is securely matched with the pins.

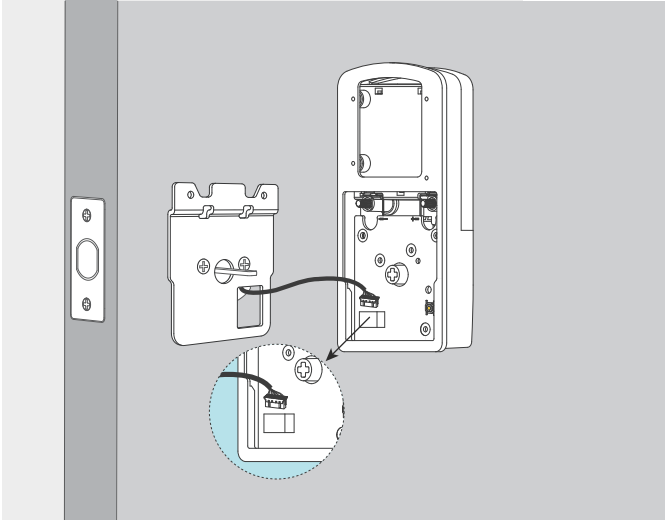

2. Face the door from the outside.

- If the hinge is on the left, the door is left-handed. Please push the direction button on the circuit board to “L”, turn the door knob to be horizontal.

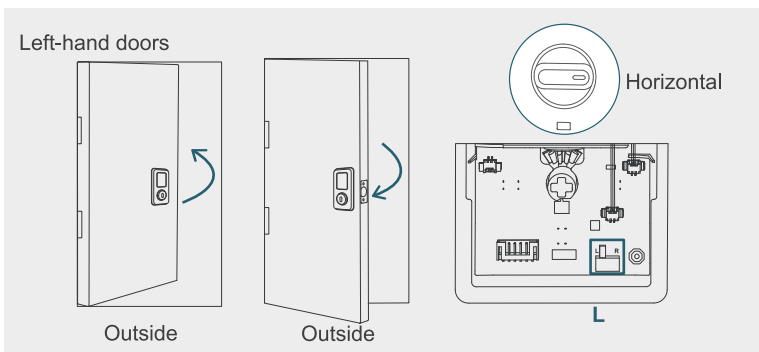

- If the hinge is on the right, the door is right-handed. Please push the direction button on the circuit board to “R”, turn the door knob to be vertical.

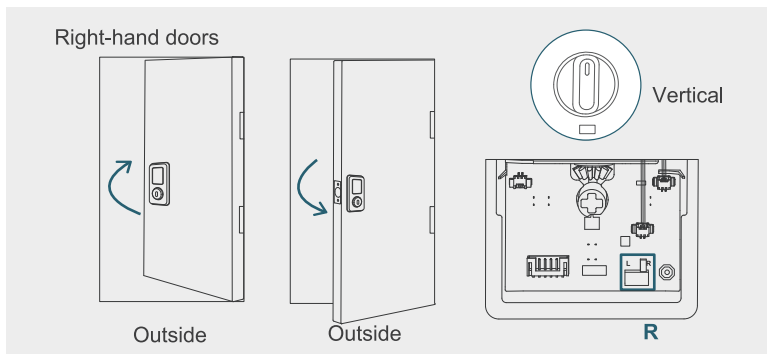

3. Screw the interior assembly.

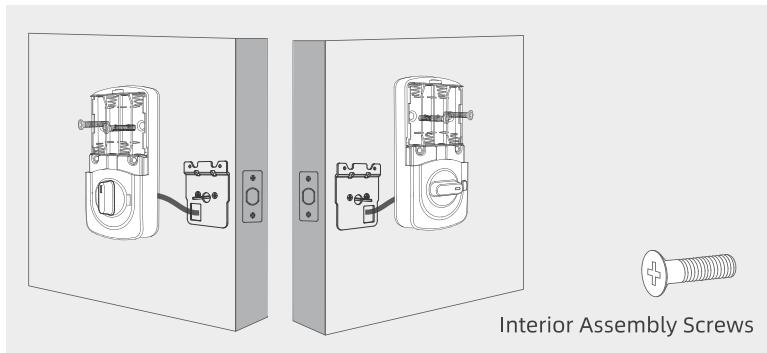

Parts Required: Interior Assembly, Interior Assembly Screws,
Screwdriver (not provided)

Step 6: Insert the Batteries

Note: Use new, non-rechargeable alkaline batteries only

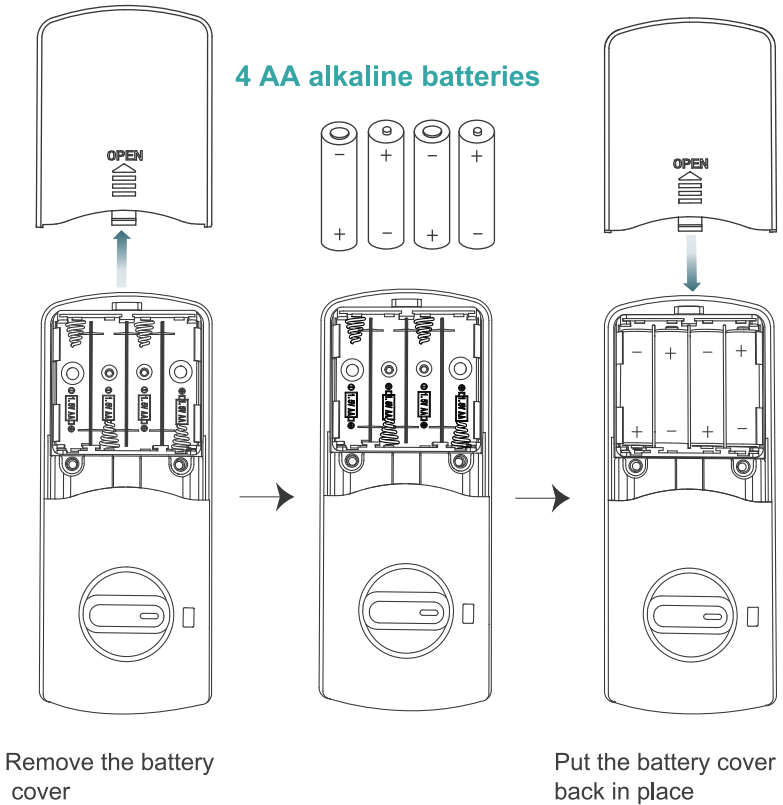

Test the Lock

1. Keep the door open.
2. Turn the knob several times to check whether the deadbolt extends and retracts smoothly.
3. **Locking Test:** Press and hold the # key for 2 seconds.
4. **Unlocking Test:** Enter the original admin passcode [123456#](#).

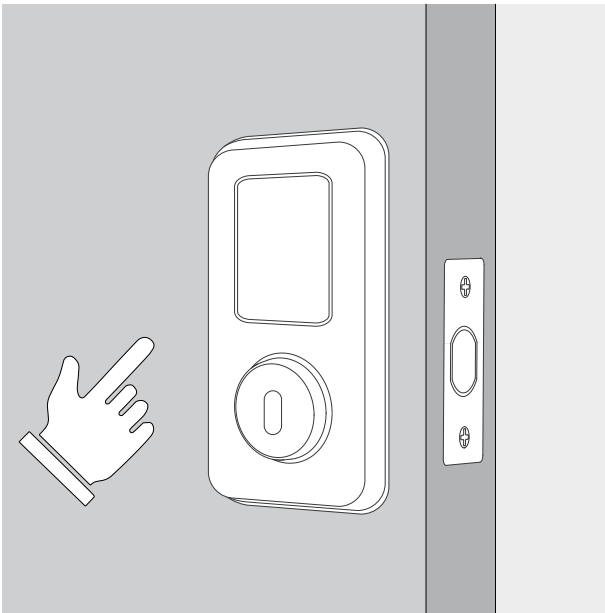

Using the App

1. Create an Account

Android: Search Next lock on Google Play or scan the QR Code below.

iOS: Search Next lock on the App Store or scan the QR Code below. Register with an email address/phone number and log into your account. (Pic 1)



Pic 1

2. Pair Your Phone with the Smart Lock

Step 1: Click the “+” icon. Please make sure your phone Bluetooth is turned on, and make sure your phone is nearby the lock within 10 feet (3 meters).

(Pic 2)

Step 2: Touch the keypad and click “Next”. (Pic 3)

Step 3: Click the red plus sign to add the lock.(Pic 4) You can rename the lock like "Front Door" then tap “OK”. (Pic 5)



Pic 2

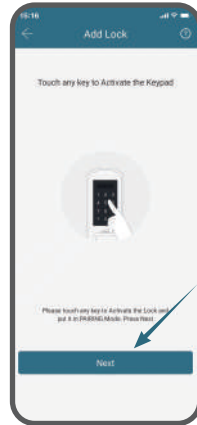

Pic 3

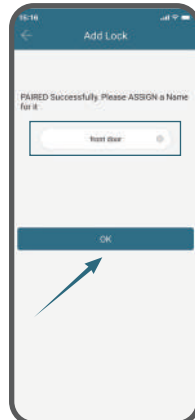
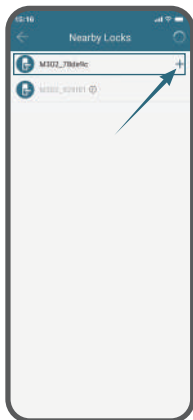

3. Select the Door Opening Direction

- Face the keypad, and select your door opening direction according to the App and Tap “OK”. (Pic 6)
- Wait until the smart lock and your phone are paired successfully. Then you are at the Next lock page. (Pic 7)

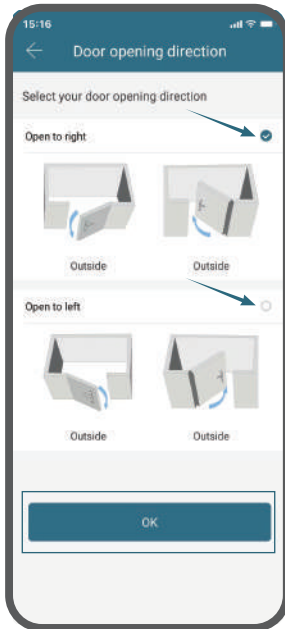

Pic 6

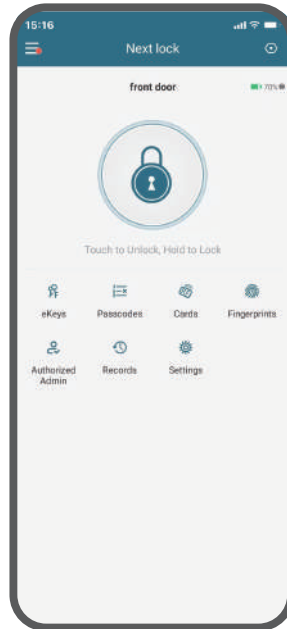

Pic 7

4. Modify the Admin Passcode

- At the Next lock page, click “Settings” icon to modify the Admin Passcode.
(Pic 8)

- Set your new Admin Passcode: Click “Basics” (Pic 9) > Tap “Admin Passcode” (Pic 10)

NOTE: The default code (123456#) will be invalid after pairing successfully.

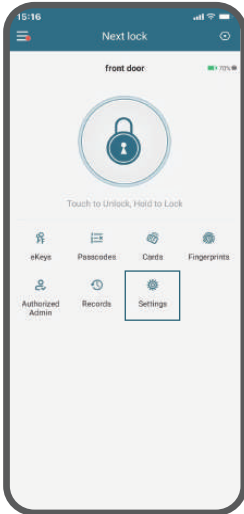

Pic 8

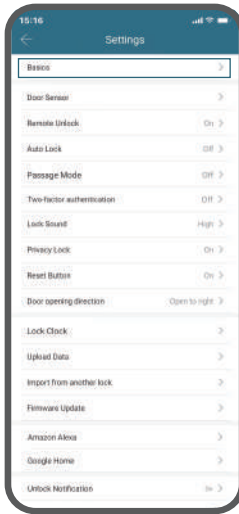

Pic 9

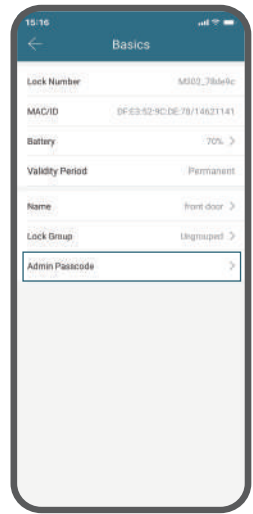

Pic 10

5. APP Homepage Overview

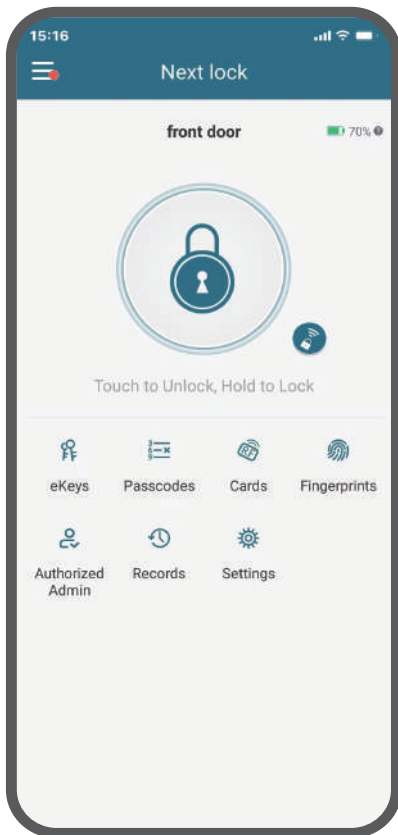

Unlock/Lock
Unlock/Lock using phone's bluetooth



Remote Unlock
Unlock remotely if G2 Gateway is connected nearby



eKeys
Others can control the lock via the app



Passcodes
Generate 5 different types of passcodes



Cards
Set up your fobs here



***Fingerprints**
Set up fingerprints. Please note that this feature is only available for fingerprint version of the smart lock.



Authorized Admin
Create and edit admins



Records
View entry times, attempts and methods. Set auto lock and passage mode here



Settings
Change door lock settings

6. Unlock/Lock by the APP (Bluetooth)

Unlock: Tap the “lock” icon. (Pic 11) Once you hear the voice prompt “unlocked”, your door is unlocked. (Pic 12)

Lock: Press the “lock” icon for seconds. Once you hear “Locked”, your door is locked. (Pic 13)

NOTE: Please make sure your phone is nearby the door lock and your phone's Bluetooth is turned on.

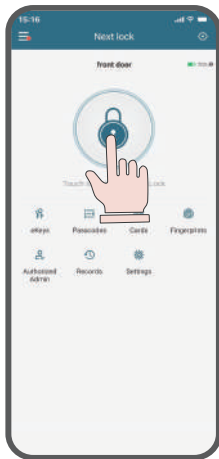

Pic 11

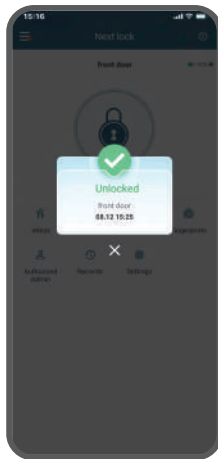

Pic 12

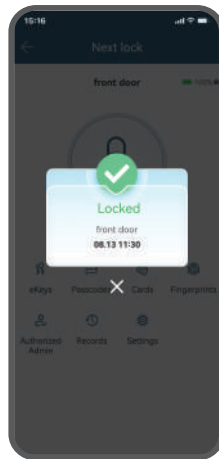

Pic 13

7. Set Customized Passcodes

Step 1: Click “Passcodes” to Passcodes page. (Pic 14)

Step 2: Click “Generate Passcode”. (Pic 15)

Step 3: Choose Custom > Name your code, such as “Tracy” and Set 4-9 digits code (Pic 16)> Click “Set Passcode” > Customized passcode generated (Pic 17).

NOTE: To generate custom codes or change any type codes, please make sure your phone is nearby the lock within 10 feet (3 meters) and the Bluetooth is turned on, unless you have the G2 Gateway and it is connected. Here are some illustrations for 6 different codes.

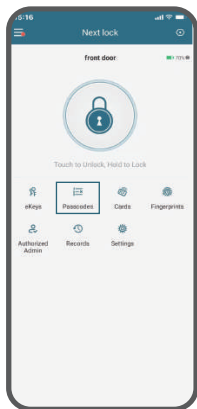

Pic 14

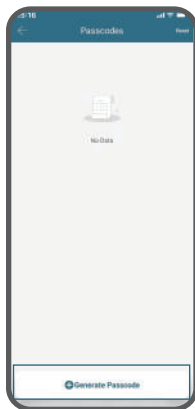

Pic 15



Pic 16

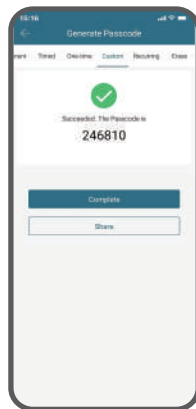

Pic 17

Permanent	Lasts permanently
Timed	Lasts between selected hours
One-time	Lasts for one use
Custom	Set your own digits such as 123456 (permanent or timed)
Recurring	Lasts during scheduled hours weekly
Erase	Erases all codes on lock

8. Share Ekeys

Step 1: At the Next lock homepage, tap “ekeys” icon to add recipient’s account (Pic 18), then choose “Send ekey” (Pic 19).

Step 2: Enter recipient’s account, it can be the phone number or email address used during the recipient’s registration. You can rename the ekey and customize the duration of the ekey. Then click “Send” (Pic 20) so that the recipient can gain the privilege to lock/unlock the door through the App (Pic 21).

NOTE: The recipient needs to register and log into his/her Next lock account before the above procedure. Because eKeys are different from passcodes. Ekeys work by sharing app access of your lock with another Next lock account. It requires the other user to download the Next lock App so they can lock/unlock through the App.

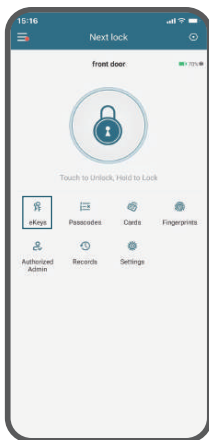

Pic 18



Pic 19



Pic 20

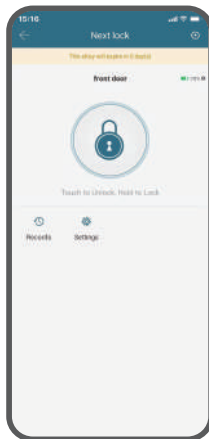

Pic 21

9. Add Authorized Admin

Authorized Admin is similar to ekeys but has more rights than ekeys. An authorized admin can do the following:

- (1) Unlock/lock the door via the App.
- (2) Generate, edit, or delete passcodes, IC cards, and fingerprints.
- (3) Adjust setting like Passage Mode, Auto Lock, and turn on/off the lock sound.

How to add authorized admin:

Step 1: At Next lock homepage, click “Authorized Admin”(Pic 22) and tap “Create Admin” (Pic 23).

Step 2: Enter recipient's account, it can be the phone number or email address used during the recipient registration (Pic 24) and click “Send”.

Step 3: The recipient can now gain the privilege (Pic 25). You can check the admin list on Authorized Admin page (Pic 26).

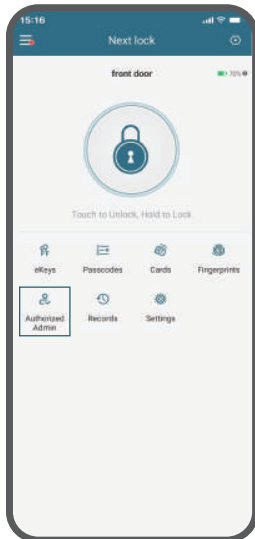

Pic 22

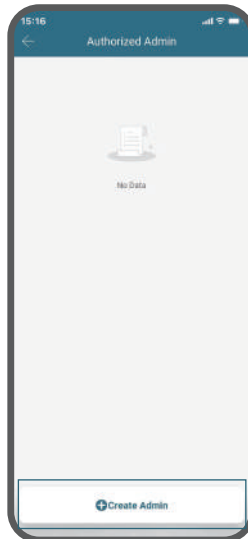

Pic 23

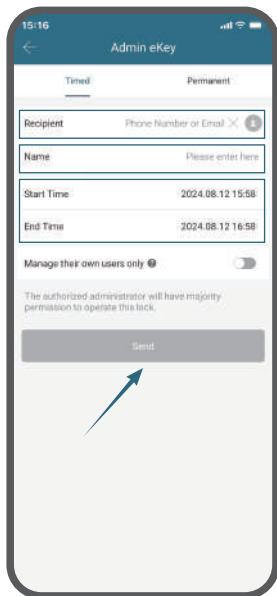

Pic 24

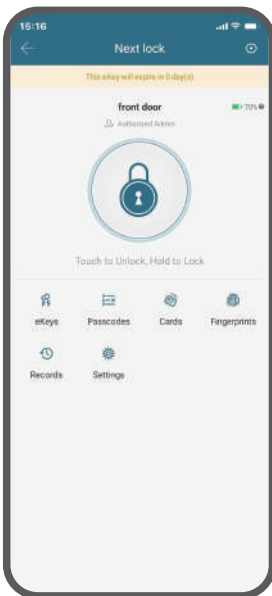

Pic 25

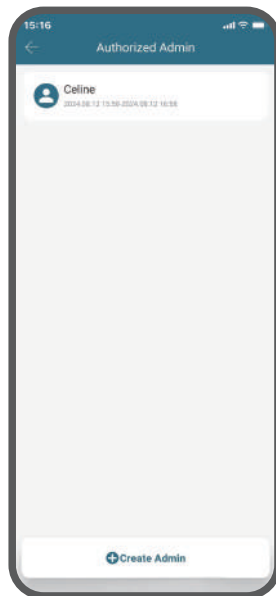

Pic 26

10. Set IC Cards (up to 1000)

Step 1: At Next lock homepage, tap “Cards” icon (Pic 27) and click “Add Card” (Pic 28).

Step 2: Set up the valid period of the IC Card and click “Next” (Pic 29).

Step 3: Once the lock prompts voice “Please swipe your card”, then place the IC card against number 5 on the keypad for seconds.

Step 4: After hearing the prompt voice “input successfully”, the IC card is recorded successfully and it can be used to unlock your door now. You can check and edit the IC card on Cards page (Pic 30).

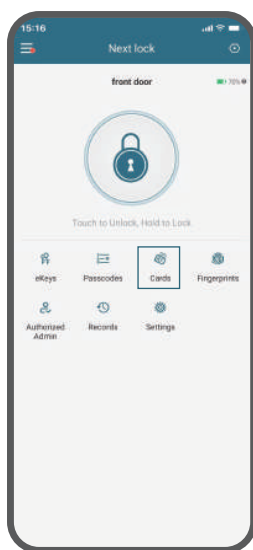

Pic 27

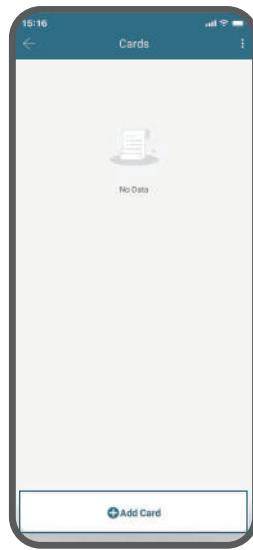

Pic 28

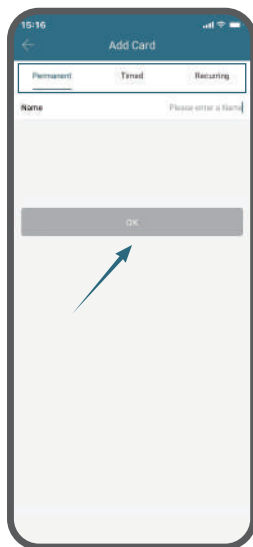

Pic 29

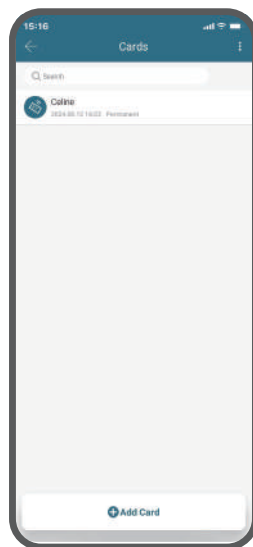

Pic 30

11. Add Fingerprints (up to 50)

Step 1: At Next lock homepage, tap on “Fingerprints” icon (Pic 31) and click “Add Fingerprint” (Pic 32).

Step 2: Set up the validity period of the fingerprint, and rename (Pic 33) then click “Next”.

Step 3: Follow instructions on App, click “Start”(Pic 34) and place your finger on the sensor.

Step 4: Following the voice prompts, you will be required to place and remove your finger from the sensor 4 times (Pic 35). After that, your fingerprint is recorded successfully (Pic 36). You can check the fingerprint list on Fingerprints page (Pic 37).

NOTE: Please note that unlocking with fingerprints is only available for fingerprint version of the smart lock.

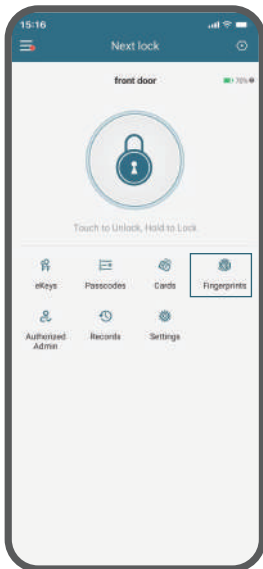

Pic 31

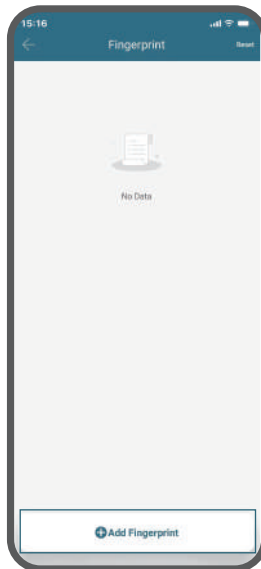

Pic 32

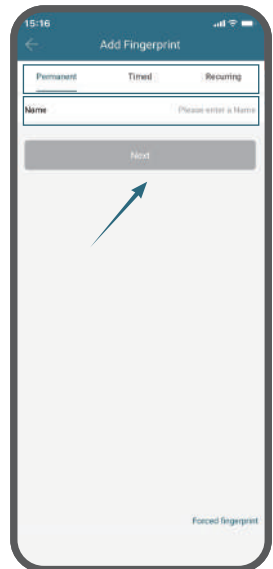

Pic 33

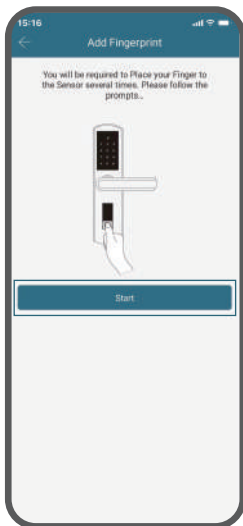

Pic 34

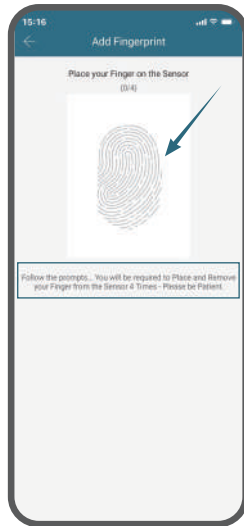

Pic 35

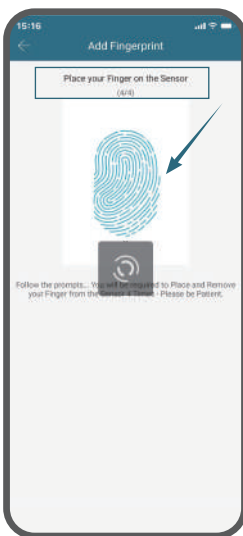

Pic 36

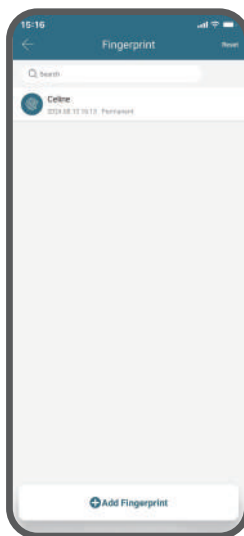

Pic 37

12. Auto Lock/Passage Mode

Auto Lock

Tap “Settings” (Pic 38) and Tap “Auto Lock” (Pic 39) > Switch on to adjust the delay time of auto-lock(Pic 40).

NOTE: After turning Auto Lock on, the door will be locked when it has been opened after the delay time you set by default.

Passage Mode

Tap “Settings” (Pic 38) and Tap “Passage Mode” (Pic 41)> Switch on to set up the specific time period by tapping “Time period”(Pic 42) > Choose specific time period for passage mode and click “OK”(Pic 43), then click “Save”.

NOTE: During the specific time period, the lock remain unlocked until it is manually locked. And Auto Lock will be disabled during Passage Mode’s validity period.

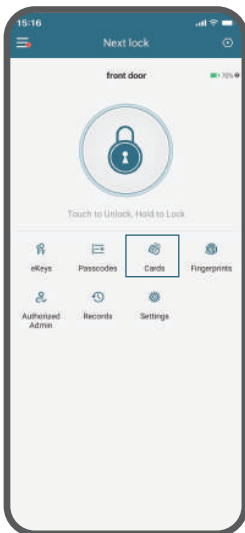

Pic 38

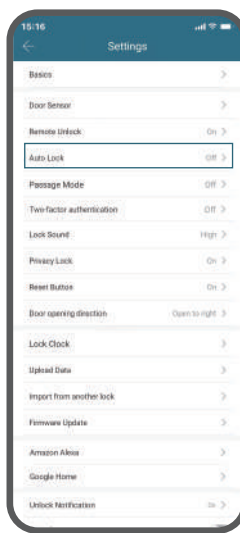

Pic 39



Pic 40

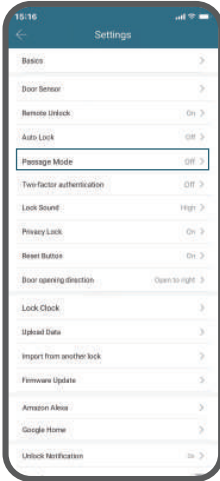

Pic 41



Pic 42

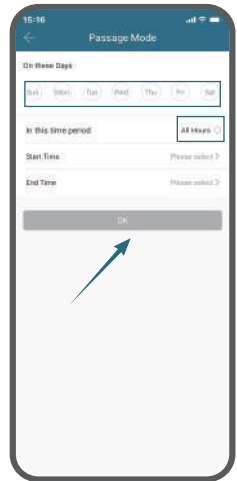

Pic 43

13. Lock Setting

Basic: You can view the basic information of the lock.

Door Sensor: You will be able to get door status and auto-lock the door with a door sensor (Sold separately).

Remote Unlock: Allows you to unlock the smart lock remotely via a gateway (Sold separately). This feature can only be turned on/off via Bluetooth.

Lock Sound: Turn on/off the sound of the lock. Adjust the lock prompt voice volume.

Door opening direction: If your door lock/unlock result is opposite as expected, you can change this feature.

Import from another lock: Allows for the transfer of eKeys, authorized admin, passcodes and IC cards from one lock to another.

Privacy Lock: Turn on/off via the reset button on the back panel. This function prevents someone from unlocking from outside.

Reset Button: Turn on/off the reset function via the reset button on the back panel.



Basic Operations

Unlock the Door

Option 1: Light up the keypad first, then enter the passcode you've set and press the # key to unlock the door. For example: 146585#

***Option 2:** Unlock the door with your fingerprint.

Option 3: Swipe the IC card to unlock the door.

Option 4: Use the mechanical key.

Option 5: Unlock your door with voice commands using Alexa or Google Home (Gateway Required).

Option 6: Unlock the door via App.

Option 7: Remotely unlock the door via App, if the gateway is paired.

NOTE: The fingerprint unlock feature is only available for the fingerprint version of the smart lock. If you have purchased the non-fingerprint version, please use other unlocking methods such as a password, physical key, or app, etc.

Thank you for your understanding and support!

Lock the Door

Option 1: Touch the # key to lock the door.

Option 2: Use the mechanical key.

Option 3: Lock the door via App.

Option 4: Enable auto-lock in the App, the door automatically locks after the set time.

Option 5: Remotely lock the door via App, if the gateway is paired.



How to Reset the Lock

Reset video: https://youtu.be/cYi_cmOiYsk

Method 1:

Step 1: Touch and light up the keypad first, then take down one battery from the compartment and wait for 5s Put the battery back and you'll see the keypad light up automatically.(If the keypad doesn't light up after you putting the battery back, try step 1 again.)

Step 2: Long press the double lockong button for 10s-15s

Step 3: When hearing "Please input the initialization passcode", please enter 000# on the keypad.

Step 4: After the lock prompts voice "Deleting administr- ator successful", it is reset successfully.

NOTE: If method 1 doesn't work, please try method 2.

Method 2:

Step 1: Uninstall the back lock by taking down the battery cover. Remove the batteries from the battery compartment. Take out the 3 screws on the back lock.

Step 2: Reload the batteries.

Step 3: Hold the Reset Button (The position is shown below) for 5 seconds. (You'll hear the sound "Please input initialization passcode" from the lock)

Step 4: Input 000# on the keypad after the sound. (You'll hear "Deleting administrator successful", which means you reset the lock successfully.)

NOTE: If method 2 still doesn't work, please contact customer service for help.

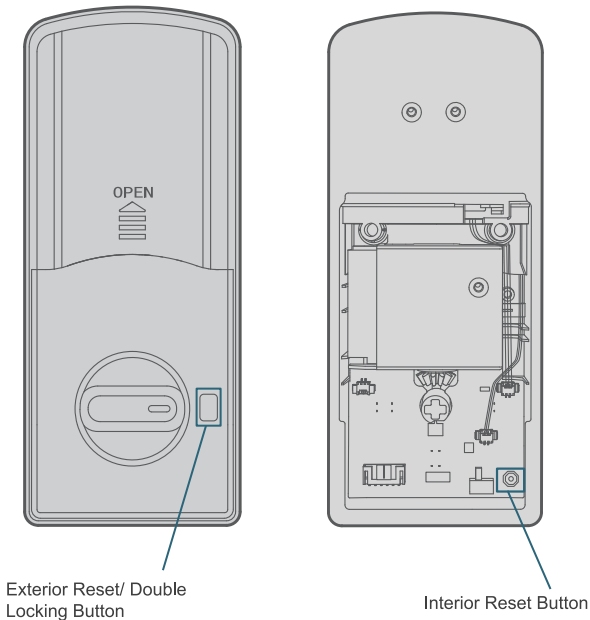

Exterior Reset/ Double
Locking Button

Interior Reset Button

Gateway Location Diagram

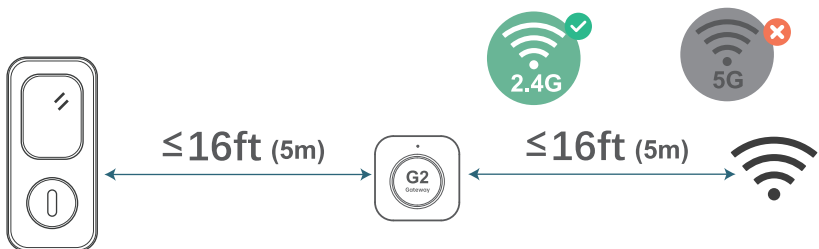

The smart lock, G2 Gateway (sold separately) and Wi-Fi router should be on the same floor to make sure enhanced connectivity.



Smart Home Integration

1. Pair the Gateway (Sold Separately)

For remote control, add the lock to the Next lock App first, and then proceed with the steps below.

Step 1: Plug in the Gateway, the blue indicator remains solid and the red indicator flashes slowly.

Step 2: Add the Gateway to the App: At Next lock homepage, tap the icon in the upper left (Pic 44) > Tap on "Gateway" (Pic 45) > Tap "+" icon in the upper right (Pic 46) > Choose G2(Wi-Fi) (Pic 47) > Click "Next" after your Gateway flashes alternately (Pic 48) > Tap the "+" icon to add the Gateway (Pic 49) > Wait for the Gateway to pair successfully (Once the Gateway is added to the App, the indicator light will flash slowly for 2s-3s).

Step 3: After adding the Gateway, you can configure network by entering Wi-Fi Password and Gateway Name and tap "OK" (Pic 50).

Step 4: The lock is connected to the Gateway now (Pic 51). You can check the Gateway status at Gateway page (Pic 52).

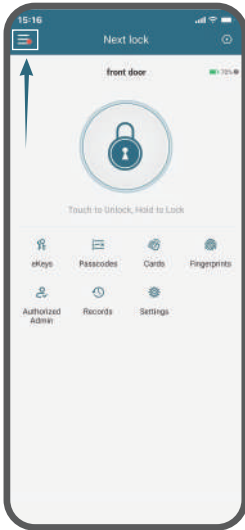

Pic 44

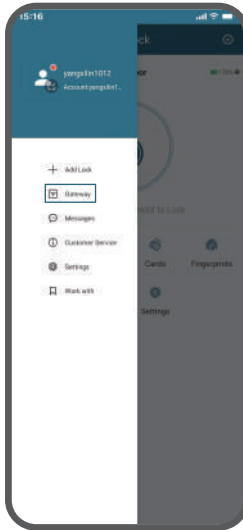

Pic 45



Pic 46

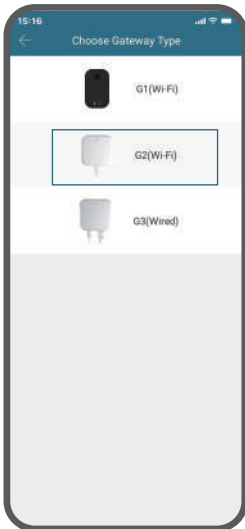

Pic 47

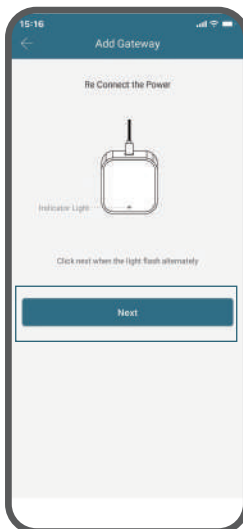

Pic 48

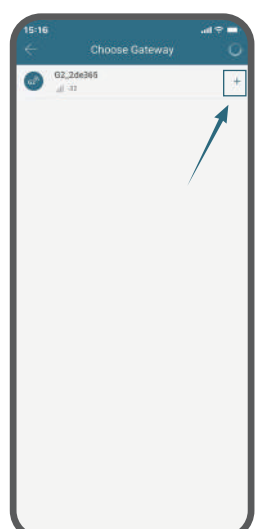

Pic 49



Pic 50

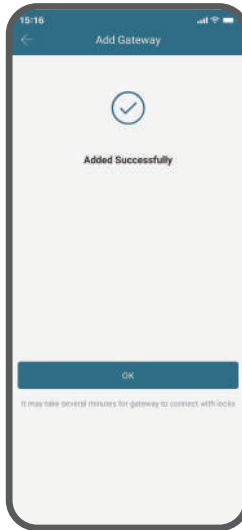

Pic 51



Pic 52

If you cannot pair the Gateway, check the following steps:

Step 1: Check if the Gateway signal is strong, if not, move the Gateway closer to the lock.

Step 2: Make sure the distance between the Gateway and the lock is within 16 feet.

Step 3: Make sure your phone and the Gateway are connected to the same Wi-Fi (The Gateway only works with 2.4 GHz Wi-Fi).

NOTE: If you have 5G Wi-Fi, you can set and add 2.4 GHz Wi-Fi by dual band router.



2. Enable Amazon Alexa (G2 Gateway Required)

Step 1: Ensure the lock and the Gateway are paired (See page 28 to 30) > Click the “Settings” icon at Next lock homepage (Pic 53) > Turn on Remote Unlock (Pic 54) > You can see Remote Unlock icon at homepage (Pic 55).

Step 2: Download Amazon Alexa App from either Google play or the App Store, then launch Amazon Alexa and log in using your Amazon account.

Step 3: Tap “More”(Pic 56) > Choose “Skills & Games” (Pic 57)> Searching for “nextlock” and tapping searching icon (Pic 58)> Enter NextLock page and click “ENABLE TO USE” (Pic 59) > Sign in your Next lock account to authorize (Pic 60)> Next lock account linked successfully to Alexa (Pic 61)> Close and then tap “Home” then choose “Locks” icon (Pic 62) > Click in and choose the upper right “setting” icon (Pic 63) > Switch on “Unlock by App” and “Enable Unlock” (Pic 64) > Setting finished.

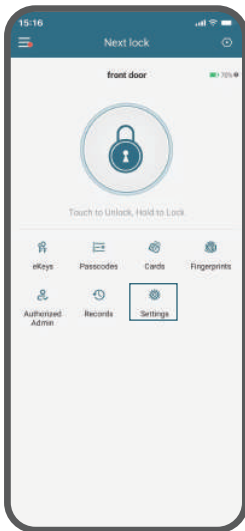

Pic 53

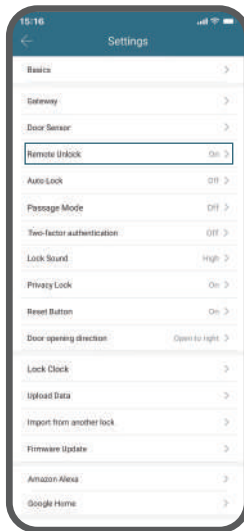

Pic 54

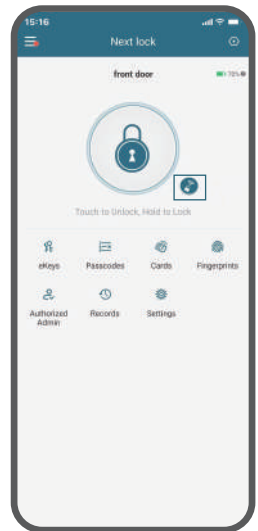

Pic 55

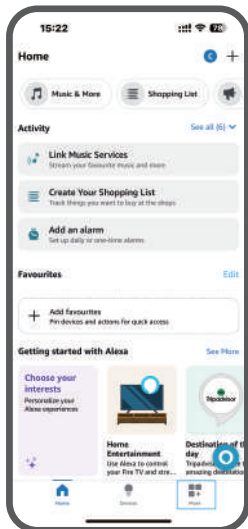

Pic 56

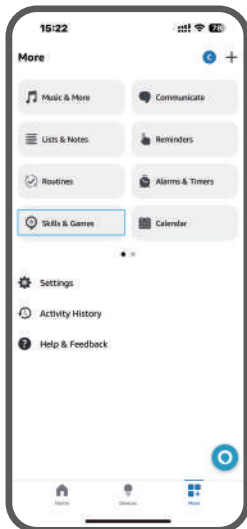

Pic 57

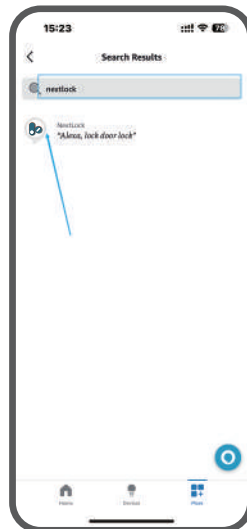

Pic 58

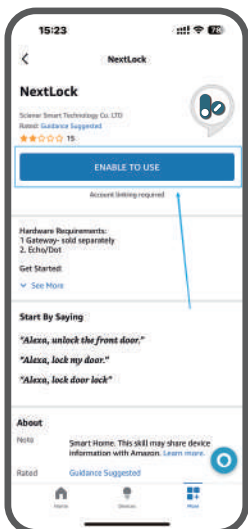

Pic 59

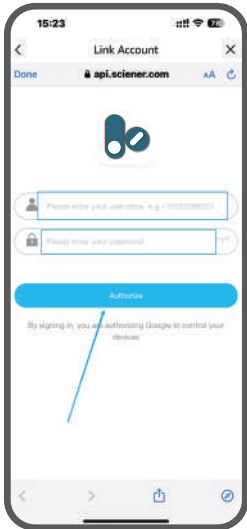

Pic 60

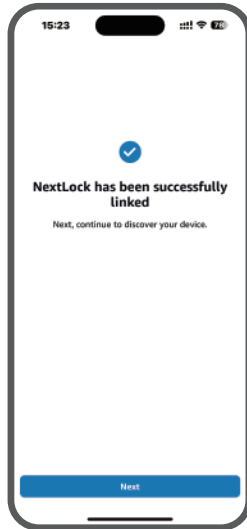

Pic 61

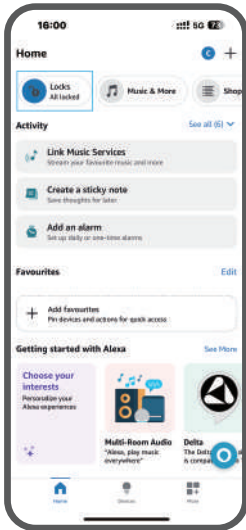

Pic 62

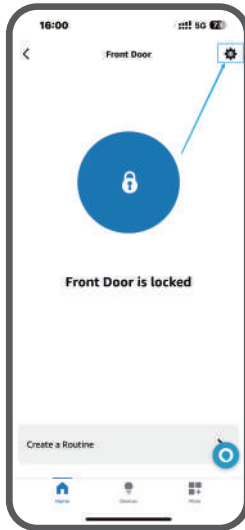

Pic 63

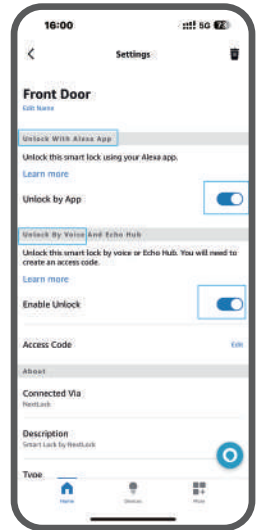

Pic 64

3. Enable Google Home/ Assistant (G2 Gateway Required)

Step 1: Make sure you have installed Google Home App and hub.

Step 2: Click the “+” button on the upper left of the App to setup device.

Step 3: In setup device page, chose “Works with Google”, to manage accounts page.

Step 4: Search for “ScienerSmart”, and enter your Next lock account in the authorize page.

Step 5: Set Google Home Security Code in Next lock App. You will be asked for this code when unlock with google home.

4. Enable PC Operation (G2 Gateway Required)

Step 1: Log in nextsmartlock.com using your Next lock App account.

Step 2: After logging in, you can remote control your door lock now (Pic 65).

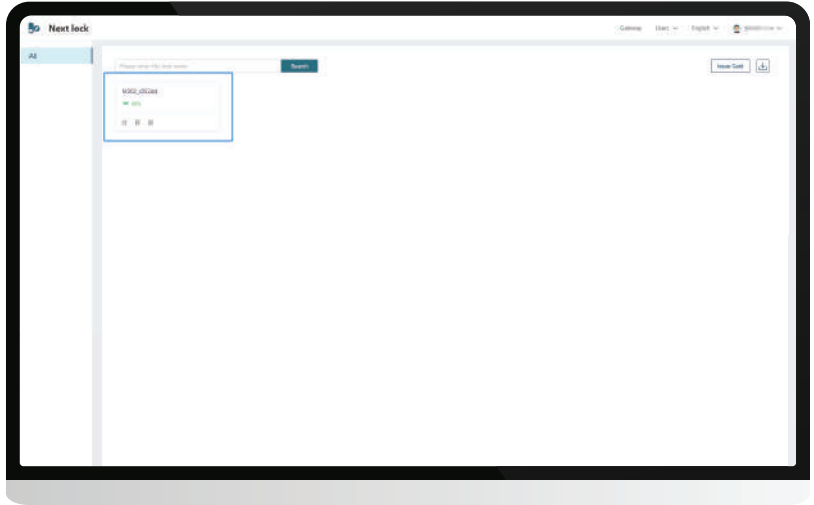

Pic 65



FAQs

Q: How to lock or unlock the door?

A: Refer to the Basic Operations-Lock the Door &Unlock the Door.

Q: How can I share access to the lock with my family and friends?

A: Refer to the parts "Share Ekeys", "Add Authorized Admin"or"Add Finger-prints".

Q: Where can I find my App account?

A : Go to the home page of the app and tap the "menu" icon in the upper left corner. Then tap your profile photo to check your account information.

Q: What should I do if I input wrong passcodes 5 times and the alarm goes off?

A: Wait for 5 minutes and try again, or use the app or keys provided to open the door.

Q: How to find and change the Admin passcode?

A: Refer to "Modify the Admin Passcode" (Make sure the Bluetooth is on and your phone is within 5 meters of the lock).

Q: What's the difference between“eKeys” and “Authorized Admins”?

A: While setting "eKeys" only allows others to unlock or lock the door via Bluetooth, setting "Authorized Admin" enables the recipients to further program the lock.

Q: How to enter the passcode on the keypad?

A: Touch the keypad to light it up, enter the passcode you have set up, then press the #key to confirm.press the # key to confirm.

**Q: Can the lock sound be muted?**

A: Stand nearby the lock, turn on your phone's Bluetooth and open the App, tap Settings→Lock Sound→Turn it off.

Q: How to prevent prying eyes?

A: Simply add extra digits before or after your real passcode and the smart lock will still unlock.

Q: How to double lock your Door?

A: Press and hold the exterior reset button for 3 seconds, you'll hear the voice prompt "Secure Lock is On", the door is double locked. Once activated, only the admin code / admin App /mechanical key can unlock the door.

Q: How to cancel double locking?

A: To undo the double locking, simply short press the exterior reset button or unlock the door by turning the knob using the admin App/admin code/mechanical key.

Q: How to make my smart door lock work with Alexa or Google Home/Google Assistant?

A: Make sure you've paired the lock with G2 Gateway (sold separately). For detailed instruction, please refer to "Smart Home Integration" part.

Q: How to set and determine the door opening direction?

A: Launch Next lock App > Tap "Settings" at homepage > Choose "Door opening direction".

**Q: How long do the batteries last?**

A: Generally speaking, the batteries can last for about 6 months. However, the actual usage time depends on the frequency of use of the door lock.

Q: How to unlock the smart Lock when the battery has run out?

A: If the battery dies, you can recharge it using the port on the outer lock. You can also open it with a physical key.

NOTE: You'll get a low battery notification when the battery is below 20%.

Q: What is the maximum distance between the G2 Gateway, smart lock, and Wi-Fi router to ensure stable remote control?

A: The maximum distance between the Gateway and smart lock is 16 feet. The maximum distance between the Wi-Fi router and the Gateway is 16 feet.

Q: Why does the user manual mention the fingerprint feature when my lock does not support fingerprint unlocking?

A: The manual includes information for both non-fingerprint and fingerprint versions. Sections on fingerprint unlocking apply only to models with that feature. Please check your purchase order to confirm if your lock includes fingerprint unlocking function.



Smart Lock Table

Model	Unlocking Methods				
	APP	Passcode (Up to 250)	Fingerprint (Up to 50)	IC cards (1000)	Keys
M1-BF	✓	✓	✓	✓	✓
M1-B	✓	✓	✗	✓	✓

Customer Service

All Hornbill products come with lifetime support. Feel free to contact us if you have any questions.

Email: support@hornbilllock.com

Toll free: 1-866-985-9909

Mon-Sun: 12:00 pm–5:00 am (EDT)



WhatsApp



Facebook Group

hornbill®

Created for Security